

FXN 1129

FLEXIBLE NEON

SUSPENDED MOUNTING CLIP

Friendly Reminder – Please read instructions carefully before operation

Suspended Mounting Rod without Wiring

Step 1

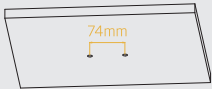

Mark the installation position of clevis on the ceiling with sufficient load-carrying capacity.

Step 2

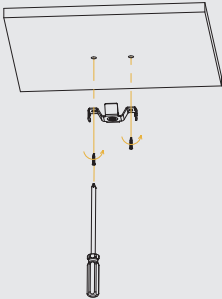

Tighten the clevis by screws.

Step 3

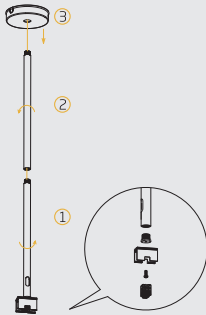

Assemble the mounting flange and the rods in order of ①②③.

Step 4

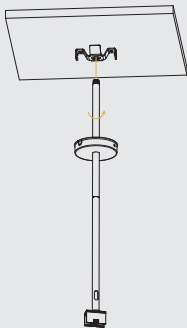

Rotate and fasten them clockwise.

Step 5

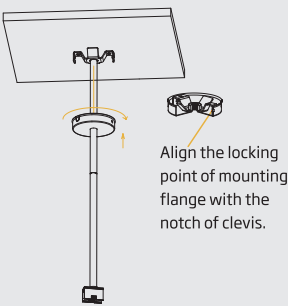

Shield the clevis by the mounting flange and rotate anticlockwise until it clicks into place.

Step 6

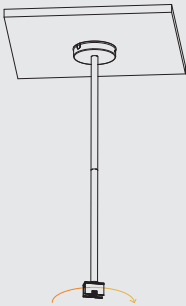

Adjust the clip to the angle you need (max. 180° in a clockwise direction).

## FXN 1129 | FLEXIBLE NEON

## SUSPENDED MOUNTING CLIP

Friendly Reminder – Please read instructions carefully before operation

## Suspended Mounting Rod with Surface Wiring

➤ Step 1



Mark the installation position of clevis on the ceiling with sufficient load-carrying capacity.

➤ Step 2

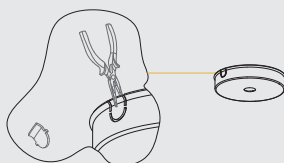

Cut a cable hole along with the pre-marked notch on the lateral side of mounting flange.

**Step 3**

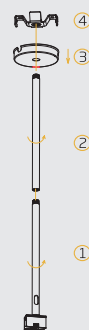

Assemble the mounting flange and the rods in order of ① ② ③ ④.

➤ Step 4

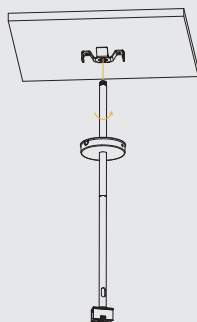

Rotate and fasten them clockwise.

**➤ Step 5**

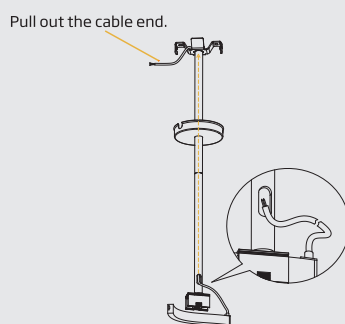

Thread the cable through slotted hole to the top of rod.

 Step 6

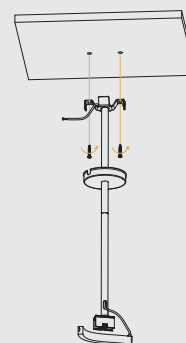

Tighten the clevis by screws.

**➤ Step 7**

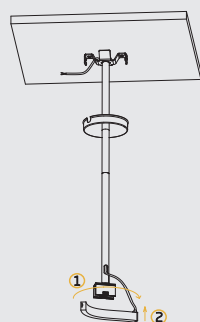

- ① Adjust the clip to the angle you need (max. 180° in a clockwise direction).
- ② Install the light to the clip and adjust the cable length.

 Step 8

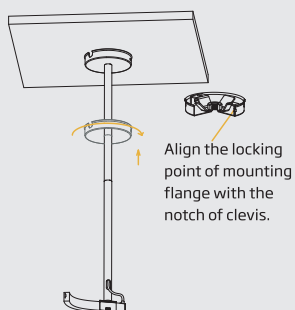

Shield the clevis by the mounting flange and rotate anticlockwise until it clicks into place.

 Step 9

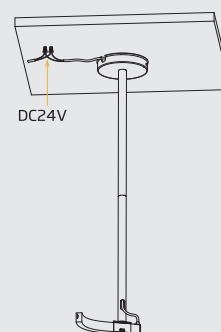

### Connect the Power DC24V

### FXN 1129 | FLEXIBLE NEON

#### SUSPENDED MOUNTING CLIP

Friendly Reminder – Please read instructions carefully before operation

#### Suspended Mounting Rod with Concealed Wiring

##### ➤ Step 1



Mark the installation position of clevis on the ceiling with sufficient load-carrying capacity, and in between punch a Ø20mm cable hole.

##### ➤ Step 2

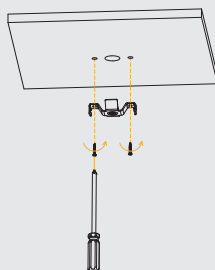

Tighten the clevis by screws.

##### ➤ Step 3

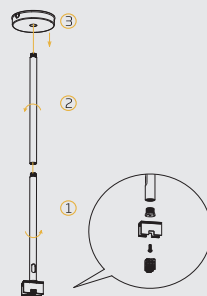

Assemble the mounting flange and the rods in order of ①②③.

##### ➤ Step 4

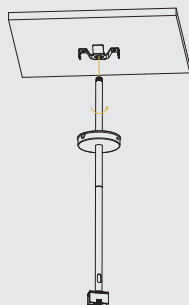

Rotate and fasten them clockwise.

##### ➤ Step 5

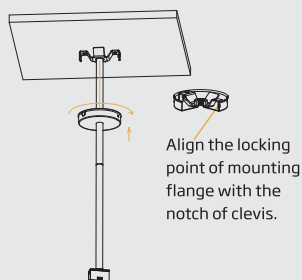

Shield the clevis by the mounting flange and rotate anticlockwise until it clicks into place.

##### ➤ Step 6

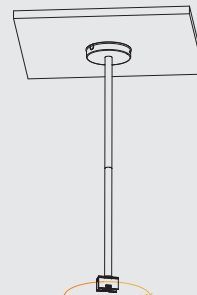

Adjust the clip to the angle you need (max. 180° in a clockwise direction).

##### ➤ Step 7

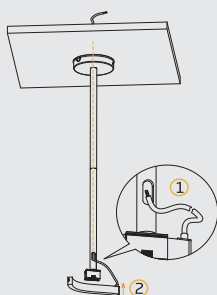

- ① Thread the cable through holes to the inside of ceiling.
- ② Install the light to the clip and adjust the cable length.

##### ➤ Step 8

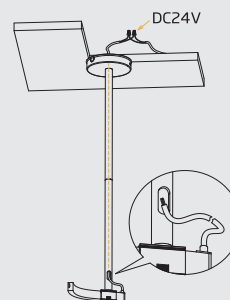

Connect the Power DC24V